

# Fleet Morris Petroleum, Inc.

P.O. Box 2347

Madison, MS 39130

601-898-3830

Fax 601-898-3214

---

March 31, 2015

Mr. Scott Weeks  
Planning and Zoning Administrator  
Office Complex Building  
125 West North Street  
Canton, MS 39046

Re: Request for Variance

Mr. Weeks:

For your consideration I would like to submit a request for a variance in the sign height at the new shell gas station we are building at 1227 Gluckstadt Road, Madison.

Our site is located in close proximity to the interstate and visibility of the sign is crucial to the success of the development. The gas station directly across the street from our site has three signs. We are installing one sign and request it to be permitted a height of 35 feet.

I have enclosed a site plan showing the location of the sign, a drawing showing the dimensions, how the sign would look and pictures of the signs at the gas station across the street.

Thank you for your consideration in this matter.

Bradley Morris  
Fleet Morris Petroleum

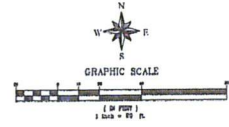
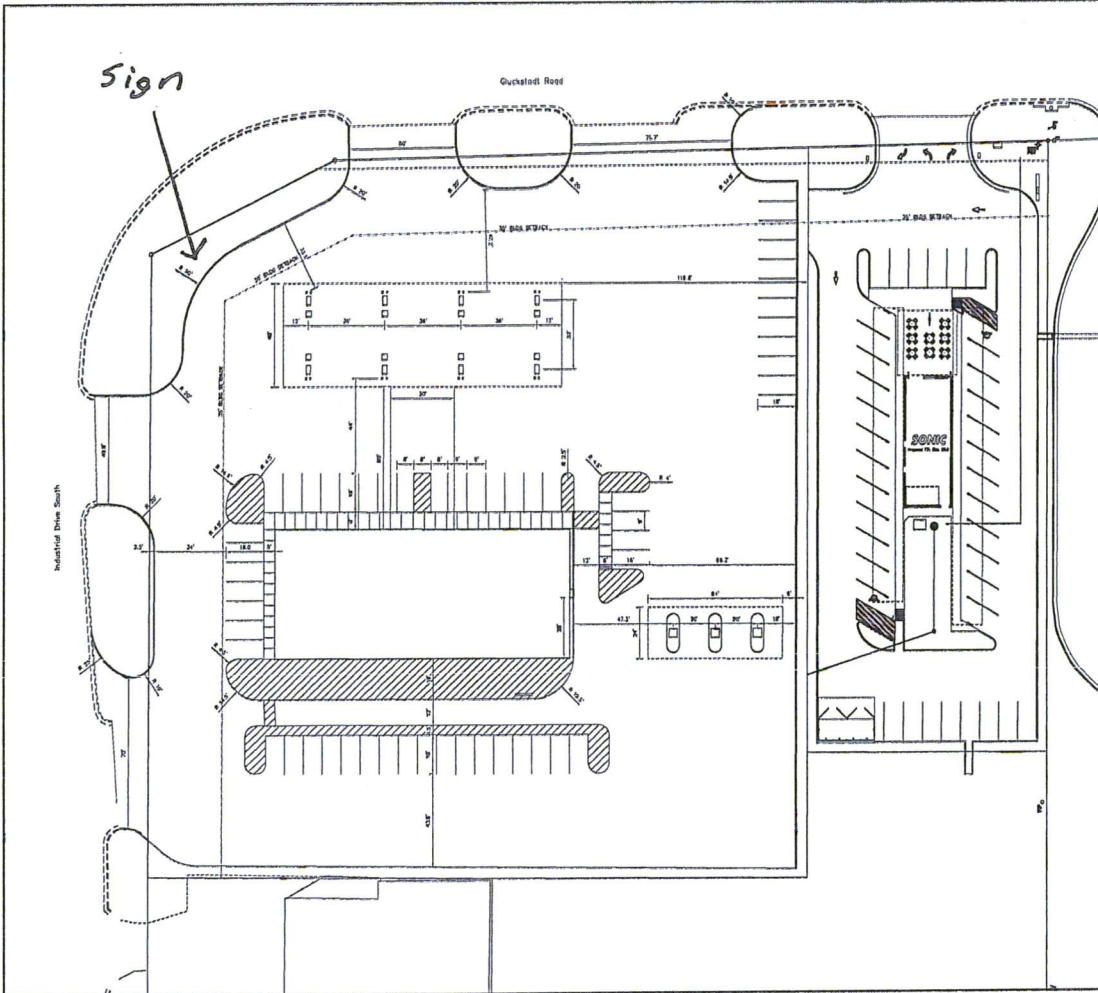

**BENCHMARK**  
ENGINEERING & SURVEYING, LLC

---

PROJECT: MORRIS CENTER  
 CLIENT: MORRIS REAL ESTATE, LLC  
 ADDRESS: 1000 MORRIS CENTER ROAD, MADISON, MS 39110  
 DATE: 08/15/2018  
 DRAWN BY: J. MORRIS  
 CHECKED BY: J. MORRIS  
 PROJECT NUMBER: B-4179

---

MORRIS CENTER  
 MORRIS REAL ESTATE, LLC  
 SITE PLAN

---

SHEET NUMBER  
**C1.0**

---

PROJECT NUMBER  
 B-4179

# RVI Evolution 9M Global System

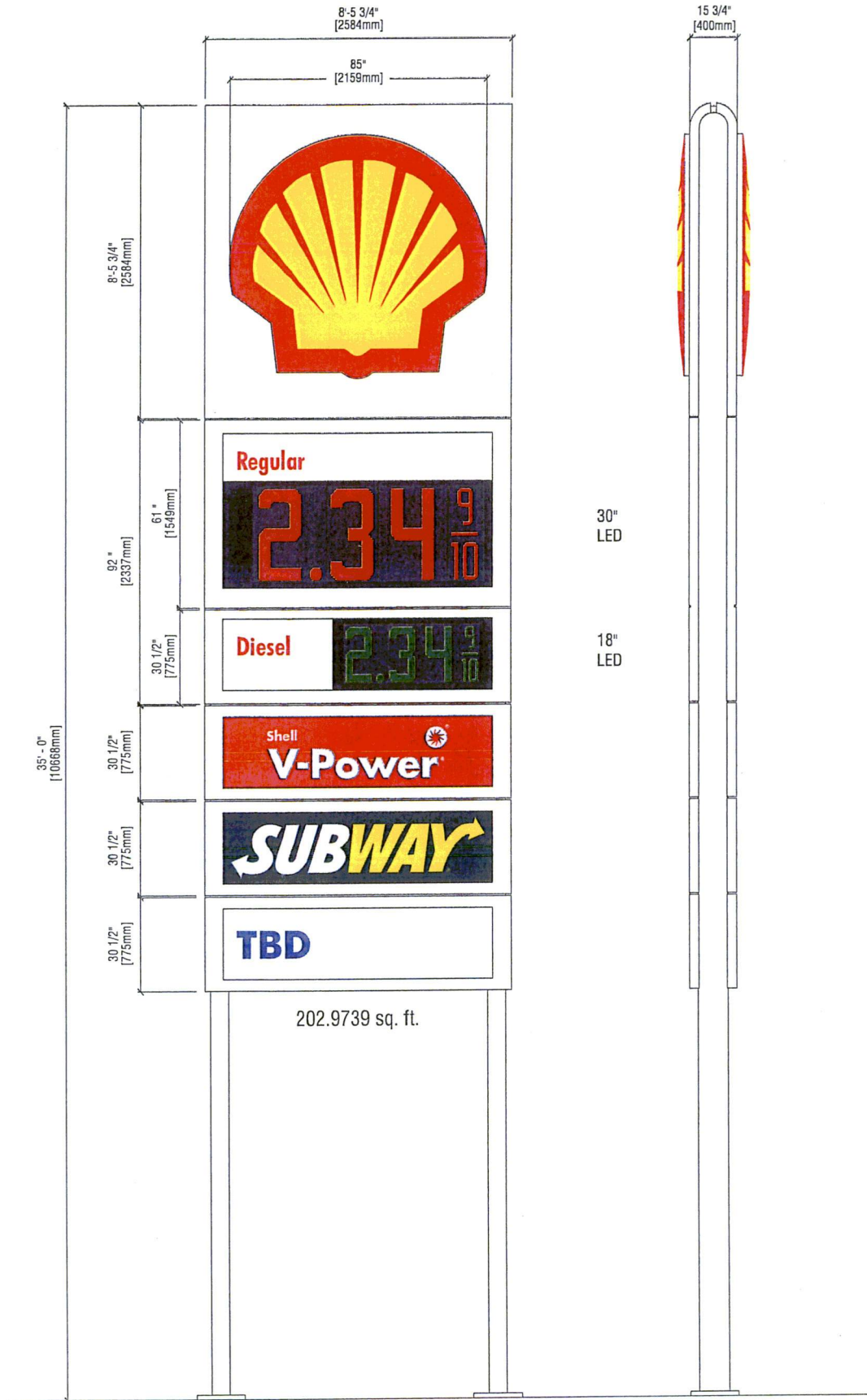

SCALE: 1/4" = 1'



**SIGN COMPANY**

www.FederalHeath.com

1500 North Bolton • Jacksonville, Texas 75766  
(903) 589-2100 • Fax (903) 589-2101

**Building Quality Signage Since 1901**

Revisions:

- 1
- 2
- 3
- 4
- 5
- 6
- 7

Account Rep: **Dan Hull**

Project Manager: **A. Martinez**

Drawn By: **Mike Lees**

Project / Location:

**Shell**  
**RVI Evolution**  
**GLOBAL**

Underwriters Laboratories Inc. ELECTRICAL TO USE U.L. LISTED COMPONENTS AND SHALL MEET ALL N.E.C. STANDARDS.  
ALL ELECTRICAL SIGNS ARE TO COMPLY WITH U.L. 48 AND ARTICLE 800 OF THE N.E.C. STANDARDS, INCLUDING THE PROPER GROUNDING AND BONDING OF ALL SIGNS.

**THIS DRAWING IS YOUR FINAL PROOF:  
IT SUPERCEDES ALL VERBAL AND  
WRITTEN COMMUNICATION. BY SIGNING  
BELOW YOU ARE AUTHORIZING US TO  
MANUFACTURE TO THESE SPECIFICATIONS.**

Client Approval/Date:

This original drawing is provided as part of a planned project and is not to be exhibited, copied or reproduced without the written permission of Federal Heath Sign Company LLC or its authorized agent. © 2008

Colors Depicted In This Rendering May Not Match Actual Material Finishes. Refer To Product Samples For Exact Color Match.

Job Number: **151876**

Date: **3.30.15**

Sheet Number: **1** of **1**

File Name: **SG151876\_e**

Design Number:





EXXON

DIESEL  
2499

EXXON

EXXON



